



## FOAM CORE - P-LAM DOOR CONSTRUCTION SPECS

Denton Door 5-Ply Premium Flush Door Construction:  
All Denton Door Company Premium Architectural  
Doors Type PC-5/FD-3 meet or exceed standards set  
forth by WDMA I.S.1-A and the AWI for PC-5 as tested  
per A.S.T.M. E-152 by Warnock Hersey International.

Top and Bottom Rails:  
1-3/8" Thick SCL  
(Stranded Composite Lumber)

Core Type:  
Polystyrene cores insulate temperature and  
sound while maintaining light weight and stiffness.

Crossband:  
1/10" High Density Fiber Crossband

Stiles:  
Hard wood over Stranded Composite Lumber (SCL)  
Backer for stained edges  
1-3/8" thick = 7/8" Solid Maple + 1/2" SCL before pre-fit

Faces:  
Plastic Laminate available from  
Wilsonart, Formica, Nevamar, Arborite

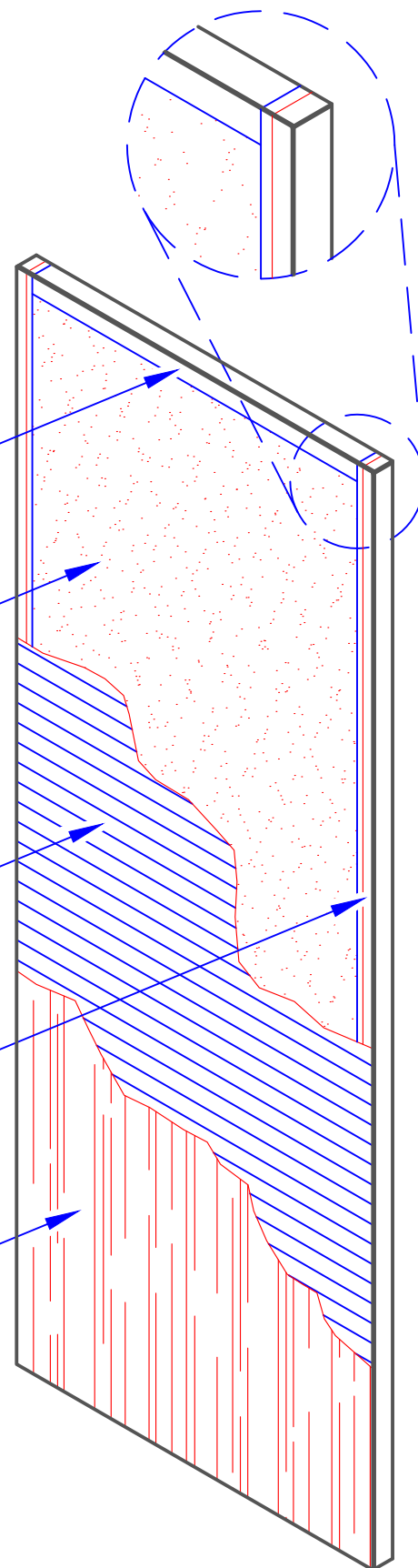

Adhesives: Meet requirements of WDMA I.S.1A, C-6

Door Thickness: 1-3/4"

Maximum Size: 4' x 9'

Warranty: Premium Architectural Doors (Lifetime Warranty)

Note: Interior use only. (Exterior use applications not warranted.)